

# Venitian

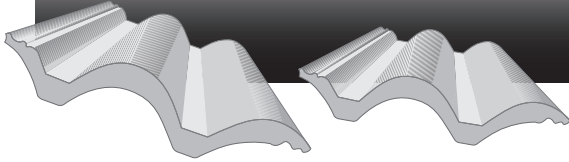

## TILE SPECIFICATIONS:

Tile Size:	420 x 330mm
<b>Linear Coverage</b>	
Effective Width:	300mm
Tile Weight/Mass:	4.9kg (average)
<b>Tiles / m<sup>2</sup></b>	
17.5° - 25°	10.42
26° Plus	9.66
<b>Mass /m<sup>2</sup></b>	
17.5° - 25°	51kg
26° Plus	47kg

## ROOFING SPECIFICATIONS:

<b>Headlap / Overlap</b>	
17.5° - 25°	100mm
26° Plus	75mm
<b>Rafter Centres (Maximum)</b>	
With 38 x 38mm batten	760mm
With 38 x 50mm batten fixed flat	900mm
<b>Battens Centre</b>	
17.5° - 25°	320mm
26° Plus	345mm

### Please Note:

- The roof structure specifications should comply with building regulations in your region.
- No allowance is made for wastage.
- Minimum roof pitch is 17.5°
- Undertile membrane mandatory 17° - 25°

VT ST GR GR = Grey	KEY:
	VT = Venitian ST = Standard AQ = Antique
VT ST RD RD = Red	VT AQ RD RD = Red
	
VT ST TC TC = Terracotta	VT AQ TC TC = Terracotta
	
VT ST SL SL = Slate	VT AQ SL SL = Slate
	
VT ST TAN TAN = Tan	VT AQ TAN TAN = Tan
	
VT ST BR BR = Brown	VT AQ BR BR = Brown
	

## PLEASE NOTE

### Antique

The primary colour throughout as per the Standard tile manufacturing process. A secondary colour is subtly mixed at random to give each tile its distinctive appearance.

### Colour Accuracy

Due to the restrictions of colour reproduction on this brochure, actual samples should always be viewed prior to ordering.

### Quality

The concrete tiles are extruded under pressure resulting in a product of high quality. Castcrete roof tiles meet with **SABS 542-2012** standard specification for concrete roof tiles.